



OPT SurgiSystems

# VANTO II WHEELS - M



# VANTO II WHEELS - M

Employing a novel design philosophy, Vanto Wheels-M is engineered to provide optimal functionality alongside sophisticated aesthetics.

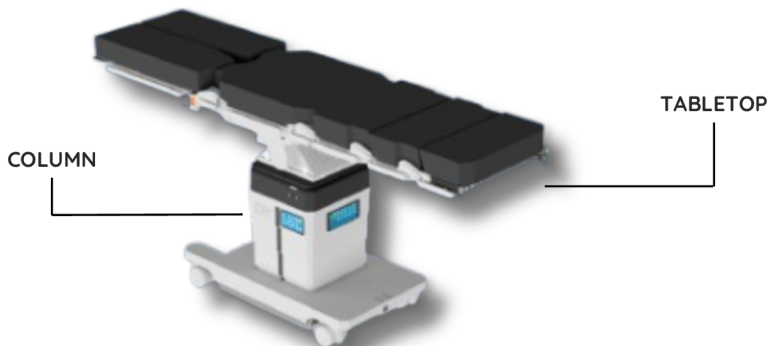

# MOBILE SURGICAL TABLE

Vanto II Wheels - M, our state-of-the-art MOBILE operating table, is a distinctive product crafted in Italy that merges advanced design with innovative technology.

The table is engineered to deliver exceptional performance, providing unmatched stability and maneuverability. With its advanced technology, each surgical procedure will be executed with greater smoothness and precision, enabling professionals to concentrate on their core competencies.

With meticulous attention to detail, Vanto II Wheels - M exemplifies not only exceptional functionality but also a hallmark of quality.

Opting for this product signifies a commitment to safety and reliability, paving the way for an improved future in surgical practices.

**MADE IN ITALY**



## BASE CONFIGURATION

The base, constructed entirely of steel, ensures stability and reliability for the entire operating table. It incorporates various functions, some of which are optional, and is fully enclosed by a panel that facilitates straightforward cleaning and sanitization.



### STABILITY

A system featuring feet, electrically operated through wired or wireless remote controls, can secure the table in the desired position, ensuring optimal stability in every surgical scenario.

### EMERGENCY

The base is outfitted with an emergency system that can be activated to disengage the braking pins and reposition the table on its wheels, thereby facilitating movement.

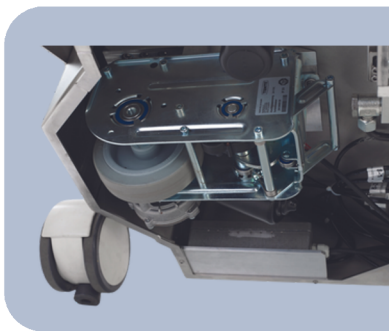

### FIFTH WHEEL

An optional retractable electric fifth wheel enhances comfort and safety during extended transfers or when transporting obese patients, and is operated via a wired remote control.

## COLUMN CONFIGURATION

The column, powered by four motors, ensures functional specifications that rank among the highest in the market.



### PANEL CONTROL

The primary control panel, seamlessly incorporated into the column alongside the leg, provides intuitive access to all table functions, guaranteeing optimal ease of use and efficient operation.

### LATER PANEL CONTROL

The lateral control system manages the movements of the column and the table, providing precise adjustments and facilitating easier access to the controls.

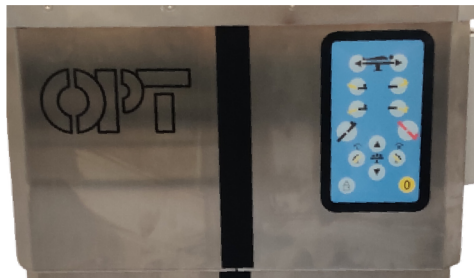

### COLUMN LIGHTS

An integrated lighting system flanking the column enhances visibility and features a color-coded light signaling mechanism that synchronizes with movements.

## CONTROL SYSTEMS



**WIRELESS REMOTE CONTROL**



**WIRED REMOTE CONTROL**

The remote controls, featuring touch screen displays, enable operators to access all relevant information regarding the table in a clear and intuitive manner, while also allowing for customization of device settings at any time.

By integrating the remote control with the column, one can ascertain in real time the position of the table, its charge status, the status of the remote control, the configuration of the operating table, and the angle of the applied sections.

## EMERGENCY MANAGEMENT SYSTEMS

### MPC/EMERGENCY PROTOCOL

The MPC control system is the sole accessory designed to provide external energy and oversee all table movements, even during emergency situations.



### EPS

The EPS system serves as the emergency apparatus designed to supply external electrical power to the operating system in cases of depleted batteries and a malfunctioning power supply.



## OPERATING TABLETOPS

The operating table is universal and appropriate for all surgical specialties, including traumatology. The VANTO system's operating table is entirely modular, consisting of a central section and configurable with various available sections (head, back, and legs). Users can select from different sections, each possessing distinct technical characteristics.

### TABLETOP 7811

A modular table designed for general surgery, radiolucent throughout its entire length, which, when paired with a comprehensive array of available accessories, readily accommodates various surgical requirements.

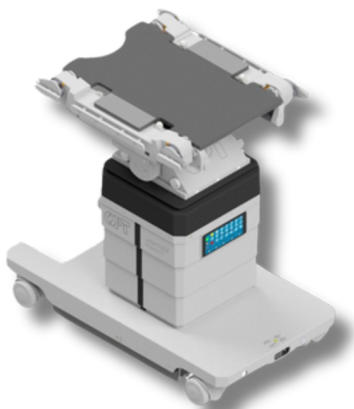

### TABLETOP 7812

The 7812, equipped with the same features as the 7811 table, facilitates isocentric movement, thereby ensuring enhanced performance.



### TABLETOPS 7830 AND 7833

The operating table is constructed entirely of carbon fiber, ensuring 360° radiolucency, a feature typically essential in vascular and hemodynamic surgery as well as in diagnostic imaging procedures. It also facilitates extensive longitudinal and lateral translational movement.

## STANDARD FEATURES

### FULLY ELECTROMECHANICAL

Equipped with highly reliable brushless motors, each responsible for a singular movement, this system provides the operator with the capability to execute combined and synchronous actions.

### AUTOMATIC SECTION IDENTIFICATION

The specialized sensors on the central table automatically identify the patient's orientation (head side/leg side) as well as the presence of installed peripherals (leg section, head section, extensions, and specialist tables).



### ANTI-COLLISION SYSTEM

The acknowledgment of the accessories utilized on the operating table, combined with the software integrated into the new VANTO II Wheels and the anti-collision system, restricts movements to avert collisions with both the floor and the table. Additionally, the anti-collision feature can be activated in smart mode to preserve the intended position.

### FIX TORQUE SYSTEM

All sections are equipped with the “Fix Torque” attachment and removal system, enabling the rapid, safe, and easily sanitized addition or removal of sections from the operating table with a single motion.



# TECHNICAL DRAWINGS

7811-000-03

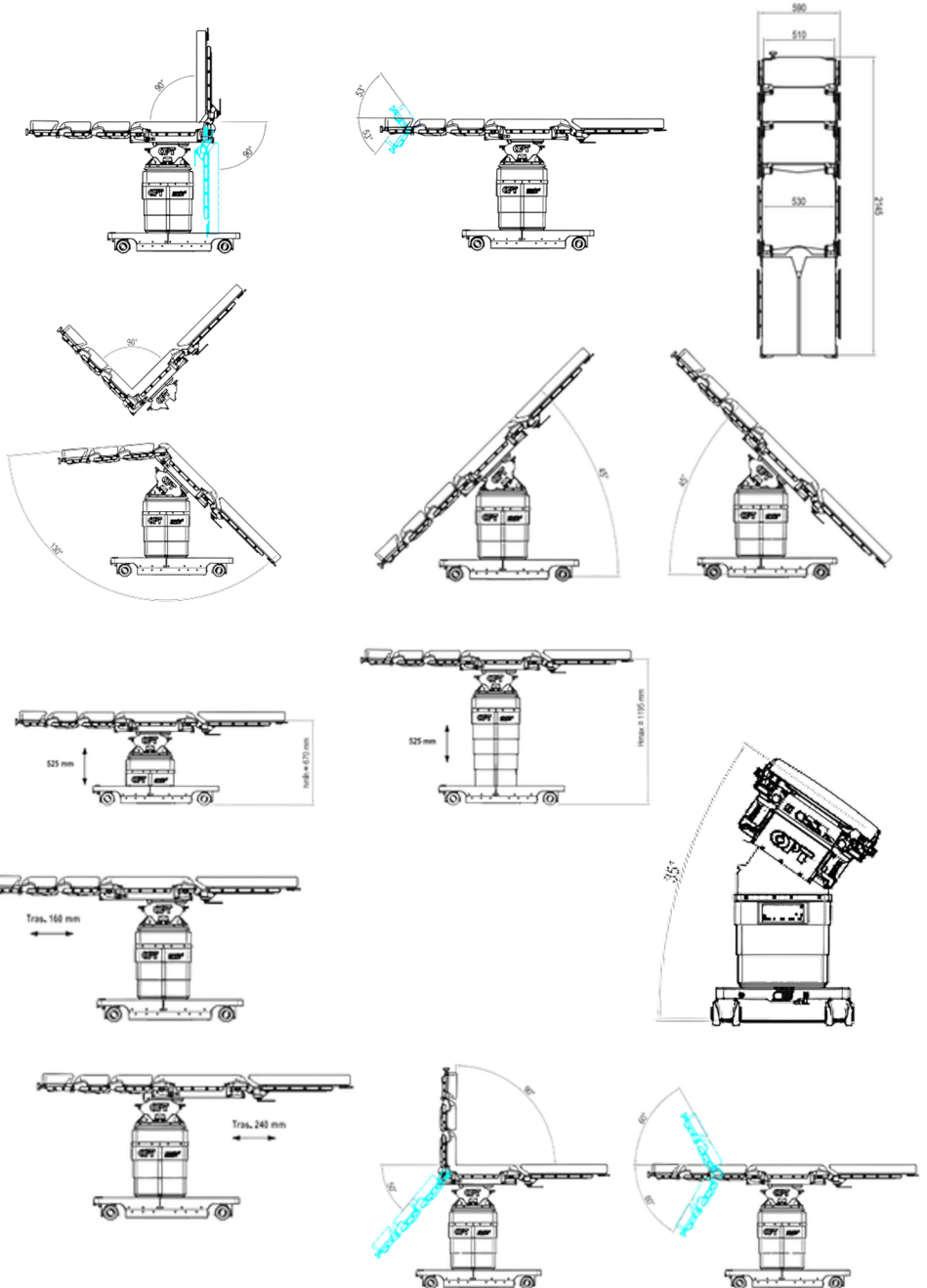

# TECHNICAL DRAWINGS

7812-000-03

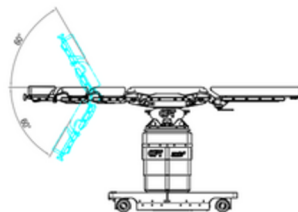
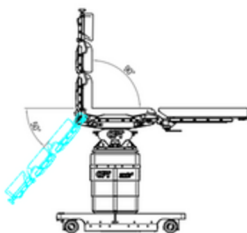
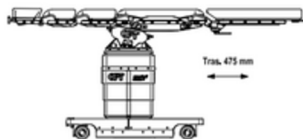
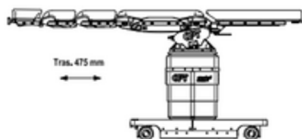
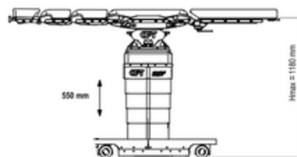
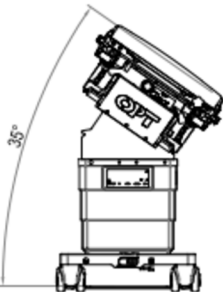
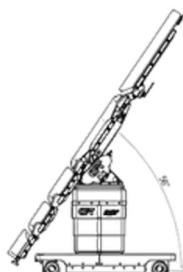
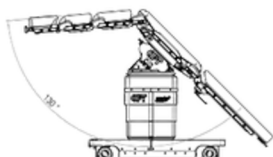
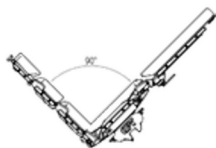
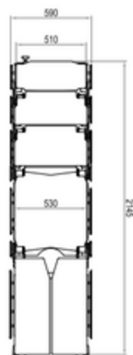
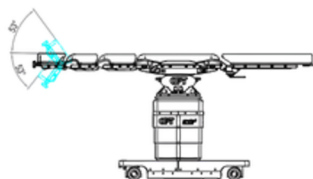
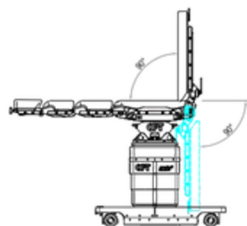

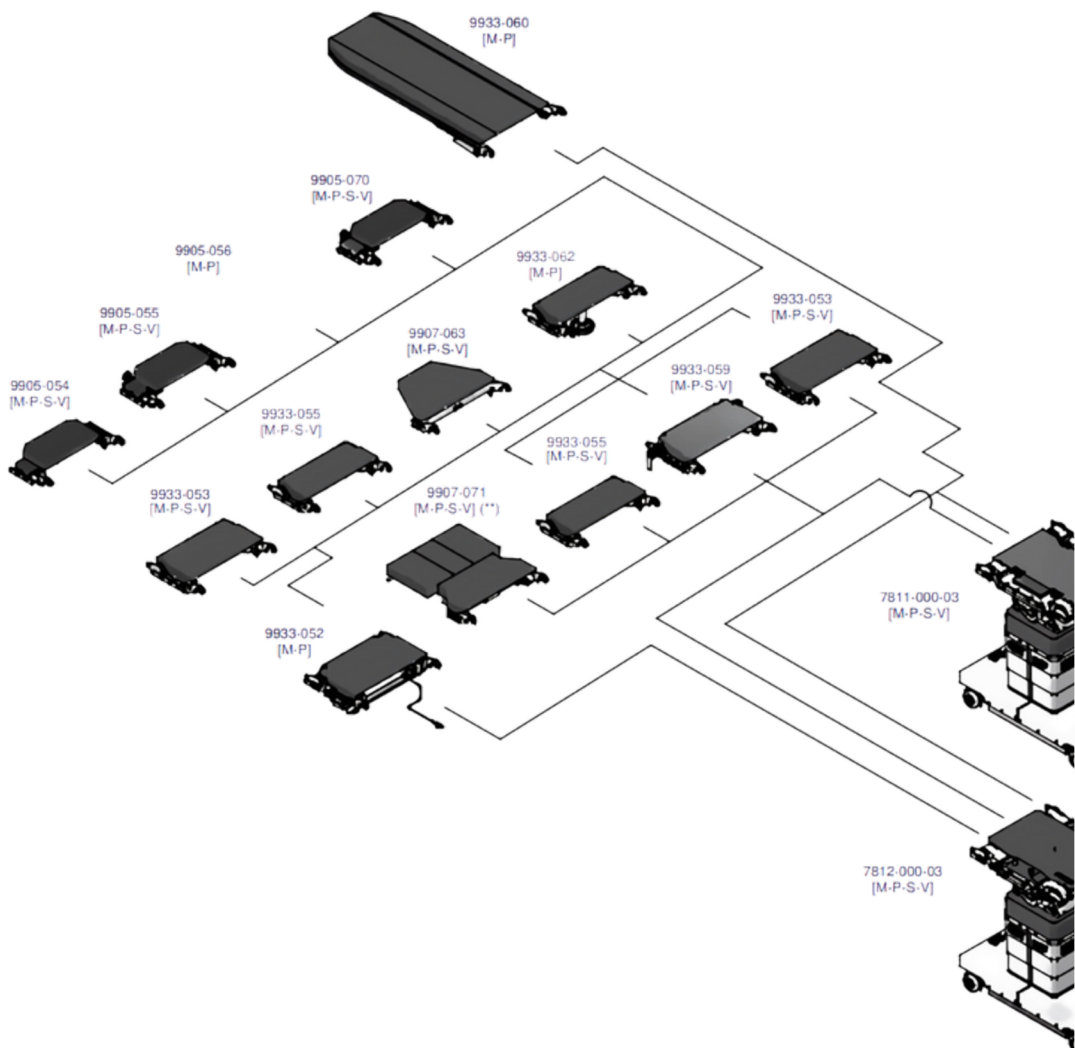

SISTEMI DI COMANDO

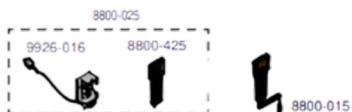

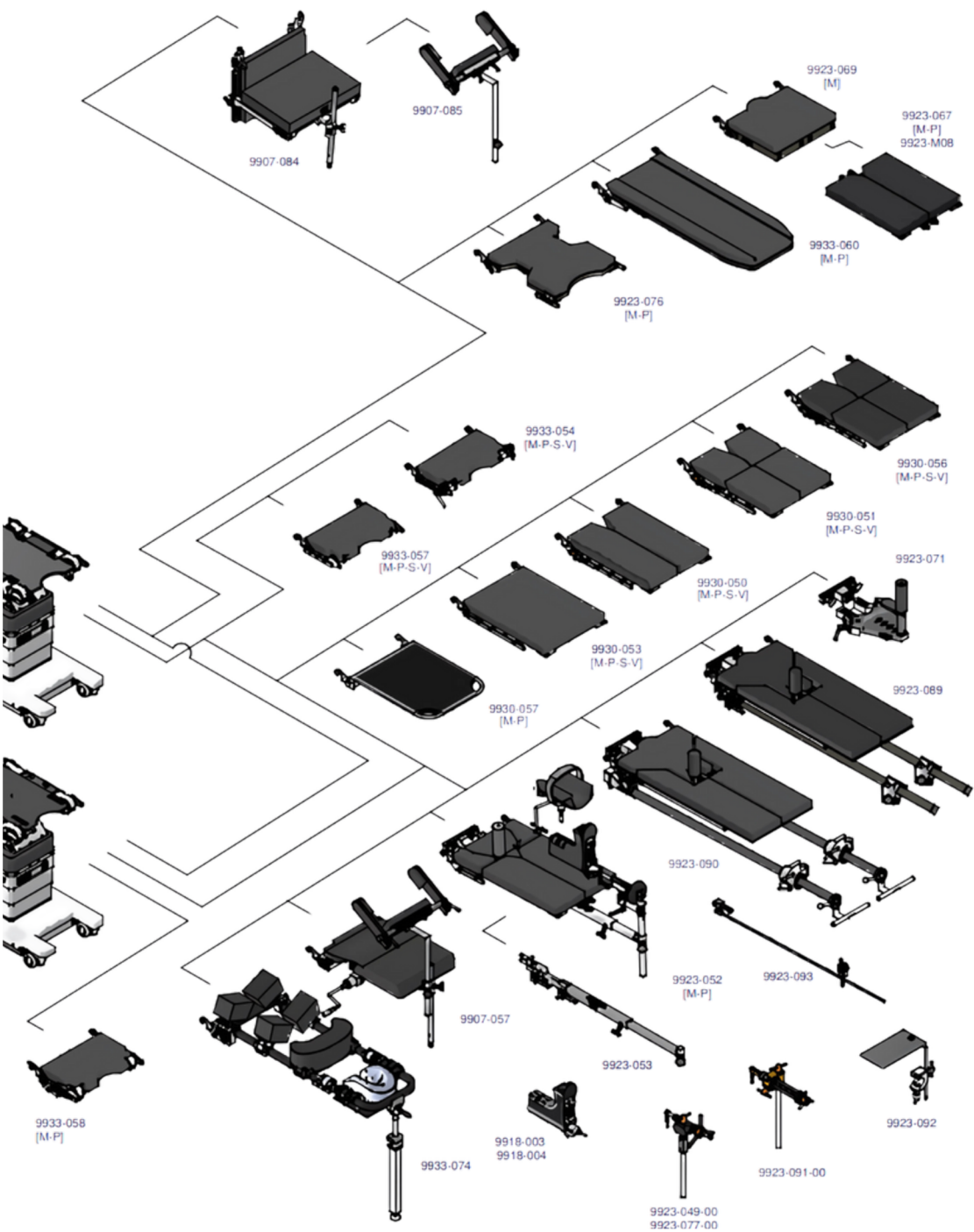



COMPANY WITH  
QUALITY MANAGEMENT SYSTEM  
CERTIFIED BY DNV  
[ISO 9001](#)

COMPANY WITH  
QUALITY MANAGEMENT SYSTEM  
CERTIFIED BY DNV  
[ISO 13485](#)

COMPANY WITH  
CERTIFIED ENVIRONMENTAL  
MANAGEMENT SYSTEM  
BY DNV  
[ISO 14001](#)





OPT SurgiSystems S.r.l.

Via Cesare Battisti, 17 - 38060 Calliano - Italy

Tel. +39 0464834336 - Fax. +39 0464 835142

[www.opt-ita.com](http://www.opt-ita.com)